

Forest Cutting Plan

Landowner Information Sheet for
Chapter 132 – The Forest Cutting
Practices Act, 304 CMR 11.00
Effective Date: 1/1/04

Please Read **BEFORE** signing your Cutting Plan and keep for your own records.

If you have any questions, call the nearest DCR regional office (listed on page 2) or

1 800-783-2311

<http://www.state.ma.us/dem/forestry/programs/index.htm>

The Massachusetts Forest Cutting Practices Act:

The Massachusetts Forest Cutting Practices Act (the “Act”) requires the improvement, maintenance, and protection of forest lands for the purpose of conserving water, preventing floods and soil erosion, improving the conditions for wildlife and recreation, protecting and improving air and water quality, and providing a continuing and increasing supply of forest products. The Act requires that a Forest Cutting Plan be filed with the appropriate Department of Conservation and Recreation (DCR) Regional office before harvesting timber to ensure that these values are protected. The cutting plan is meant to satisfy the law, reflect **your objectives for your land**, and help you understand the proposed harvest.

Your Objectives:

The most important information on a Forest Cutting Plan is the landowner’s objectives. You will be asked to choose between Long-term Forest Management or a Short-term Harvest. This choice will determine which trees will be harvested and which will remain; **this decision will also determine the future condition of the forest for decades to come.** You will indicate your objective by checking one of two boxes in the Landowner Signature Section on page 4. Information on the two choices is provided below.

Long-term Forest Management

Long-term Forest Management means the planned management of the forest to achieve one or more of the following objectives: produce immediate and maximize long-term income from harvesting activity, maintain or enhance wildlife habitat, improve recreational opportunities, protect soil and water quality, or produce forest specialty products such as maple syrup.

This strategy employs the science and art of forestry to help you manage your property to achieve multiple objectives, preserve future management options, and maximize economic return.

Short-term Harvest

Short-term Harvest means the selection of trees for cutting based on the economic value of individual trees which commonly results in a residual forest stand dominated by poor quality trees and low value species. While this strategy produces immediate income and meets the **minimum** standards of the act, it does little to improve the future condition of the forest. A Short-Term harvest can limit future income and management options by:

- Removing trees before they reach economic maturity
- Leaving little value for future harvests
- Retaining slow growing or poor quality trees
- Removing mostly large diameter or high value species (such as oak) that could act as a seed source for growing future high quality trees or provide food for wildlife

As the landowner, the type of management implemented on your property is ultimately your decision. The DCR hopes you will consider taking a long-term management approach, but most importantly, we want you to make an informed decision by having your forest management options explained. DCR service foresters can provide more information about these options. Contact the nearest office listed below.

Your Responsibilities

A harvest of forest products can have significant impact on your forest and your finances. The cutting plan identifies the standards for cutting, logging, and engineering minimally necessary for protecting the named public values established in the Forest Cutting Practices Act (MGL Ch 132). It is your responsibility to ensure that the harvesting activity complies with the approved forest cutting plan.

The DCR recommends that landowners protect their interests when selling timber. You are encouraged to explore all your options including hiring a licensed professional to plan, oversee or conduct your timber sale, obtaining competitive proposals from licensed foresters for their professional services or inviting competitive bids from licensed loggers. In addition, you should have a separate timber sale contract that addresses your own expectations for items such as payment schedules, road conditions, aesthetics, and other concerns not covered by the Forest Cutting Practices Act and its regulations.

A Forest Management Plan (Chapter 61, Chapter 61A, Forest Stewardship Plans)

The DCR recommends the best way to make decisions about implementing long-term objectives is within the framework of a forest management plan prepared by a Massachusetts licensed forester. Forest management plans provide you with maps, forest stand descriptions, and management recommendations based on objectives that you identify. A forest management plan is one requirement to receive favorable tax treatment for your forestland under M.G.L. Chapter 61 or Chapter 61A. You may also elect to join the Forest Stewardship Program, in which cost-sharing may reimburse a portion of the expense of having a forest management plan prepared. This Stewardship Plan makes you eligible to receive additional cost-share to do a variety of forest management practices. Current DCR policy stipulates that forest cutting plans for forest lands classified under Ch. 61 or 61A or certified under the Forest Stewardship Program must be prepared by a Massachusetts licensed forester or the landowner. Contact a DCR service forester for more information on all of these programs, or visit our website at <http://www.state.ma.us/dem/forestry/programs/index.htm> and click on Service Forestry.

DCR Regional Offices

Southeastern Massachusetts
Region 1 Headquarters
(508) 866-2580

Central Massachusetts
Region 3 Headquarters
(978) 368-0126

Berkshires
Region 5 Headquarters
(413) 442-8928

Northeastern Massachusetts
Region 2 Headquarters
(978) 369-3350

Connecticut Valley
Region 4 Headquarters
(413) 545-5993

If you are not sure which
office to call dial:
(800) 783-2311

Forest Cutting Plan

and Notice of Intent under M.G.L.
Chapter 132 – The Forest Cutting
Practices Act, 304 CMR 11.00
(Effective Date: 1/1/04)

For DCR Use Only:

File Number	_____	Case No.	_____
Date Rec'd	_____	Nat. Hert.	_____ / _____
Earliest Start	_____	Nat. Hert. Imp.	_____
River Basin	_____	Pub. Dr. Wat.	_____
Gen. Obj.	_____	ACEC	_____

Site Information

Location

Town Haverhill & Merrimac
Road Brandy Brow Road & Hadley Road
Acres 49 +/- Proposed Start Date 11/1/2013
Vol. MBF 201.332 Vol. Cds. 42 +/- Vol. Tons 1,225 +/-

Plan Preparer

Name Gary H. Gouldrup, NEFCo
Address 72 Townsend Street

Town, State, Zip Pepperell, MA 01463
Phone 978-433-8780
Type of Preparer Mass. Licensed Forester - LF
*Mass. Forester License # 81
*Required for land under Ch61, Ch61A or Forest Stewardship

Landowner

Name City of Haverhill
Mailing Address C/o Robert Moore
City Hall Room 210, 4 Summer Street
Town, State, Zip Haverhill, MA 01830
Phone 978-374-2334
Ch61 ☐ Ch61A ☐ CH61B ☐ Stew ☒ *Case # _____
FSC GC ☐ CR ☐ CR Holder _____

Licensed Timber Harvester**

Name _____
Address _____
Town, State, Zip _____
Phone _____
Mass. Lic. Harvester # _____
**This information may be supplied after the plan is approved, but before work begins.

Best Management Practices

Stream Crossings

Indicate location on map	SC-1	SC-2	SC-3	SC-4
Type of Crossing	BRCU	BRCU	NA	NA
Existing Structure	No	No		
Type of Bottom	GR	GR		
Bank Height (ft)	1'	1'		
Stabilization	MUCO	MUCO		

Wetland Crossings

Indicate location on map	WC-1	WC-2	WC-3	WC-4	WC-5
Length of Crossing	NA	NA	NA	NA	NA
Mitigation					
Stabilization					

Filter Strips

Indicate location on map	FS-1	FS-2	FS-3	FS-4	
Width (50', 100', or VA)	VA	50	VA		

Harvesting in Wetlands

Indicate location on map	HW-1	HW-2	HW-3	HW-4
Forest Type (see pg 2)	WH	NA	NA	NA
Acres to be Harvested	0.50			
Resid. Basal Area (>50%?)	Yes			

Service Forester Comments

Codes

Type of Preparer	Type of Crossing	Stabilization	Mitigation	Type of Bottom
LF Mass. Lic. For.	CU Culvert	SE Seed	FR Frozen	LE Ledge
TH Lic. Tim. Har	BR Bridge	MU Mulch	DR Dry	ST Stony
TB Timber Buyer	FO Ford	CO Corduroy	OT Other	MU Mud
LO Landowner	PO Poled	ST Stone		GR Gravel
OT Other	OT Other	HB Hay Bales		OT Other
		OT Other		

Note:
Applicant must provide DCR with all relevant information before plan may be approved and cutting may begin. Some forestry activities, such as prescribed burning and pesticide or fertilizer application may require additional permits. Consult MA Forestry BMP Manual for further information.

Forest Cutting Plan

Narrative Page (Effective Date: 1/1/04)

Use this page to provide further explanation or if Other (OT) was used in any category on pages 3 or 4.

Landowner City of Haverhill

Town Haverhill

File Number _____

BMPs

Designation of Trees

Regeneration & Future Condition

Use this Section to provide further explanation or if Other (OT) was used in any category in the Best Management Practices Section on Page 3.

- 1) Flag skid trails prior to harvesting
- 2) Whole-tree chipping will be conducted during the harvest for fire protection and aesthetic purposes
- 3) Install Culvert & Bridge at SC-1 & SC-2 as needed. Install poles in the stream bed if necessary.
- 4) Gravel from adjacent pits may be used to build approaches to the stream crossings and culverts.

Use this Section to describe the types of trees to be harvested and/or retained if Other (OT) was used for "Designation of Trees" in the Stand Treatment Section on page 4.

Stand No.	Species to be Cut	Size of Trees to be Cut	Quality of Trees to be Cut	% BA/Acre Removed
NA	NA	NA	NA	NA

Use this Section to describe how Chapter 132 requirements will be met if a non standard system (HG, DL, or OT) was used for the "Type of Cut" in the Cutting Standards Section on page 4.

Stand No.	Source of Regeneration (ex. AD, SE)	How will Regeneration be obtained/protected? If using AD - Describe the species present and how the regeneration will be protected If using SE - Describe the source of the seed and the number of seed trees/acre
-----------	---	--

NA	NA	NA

Stand No.

Desired Future Condition

Describe what the stand is expected to look like five years from the harvest, including the condition of the overstory & understory

1, 4, & 14	See Forest Stewardship Plan on file with DCR and the Haverhill Conservation Department.



Land in Haverhill, MA
East Meadow Brook Lot





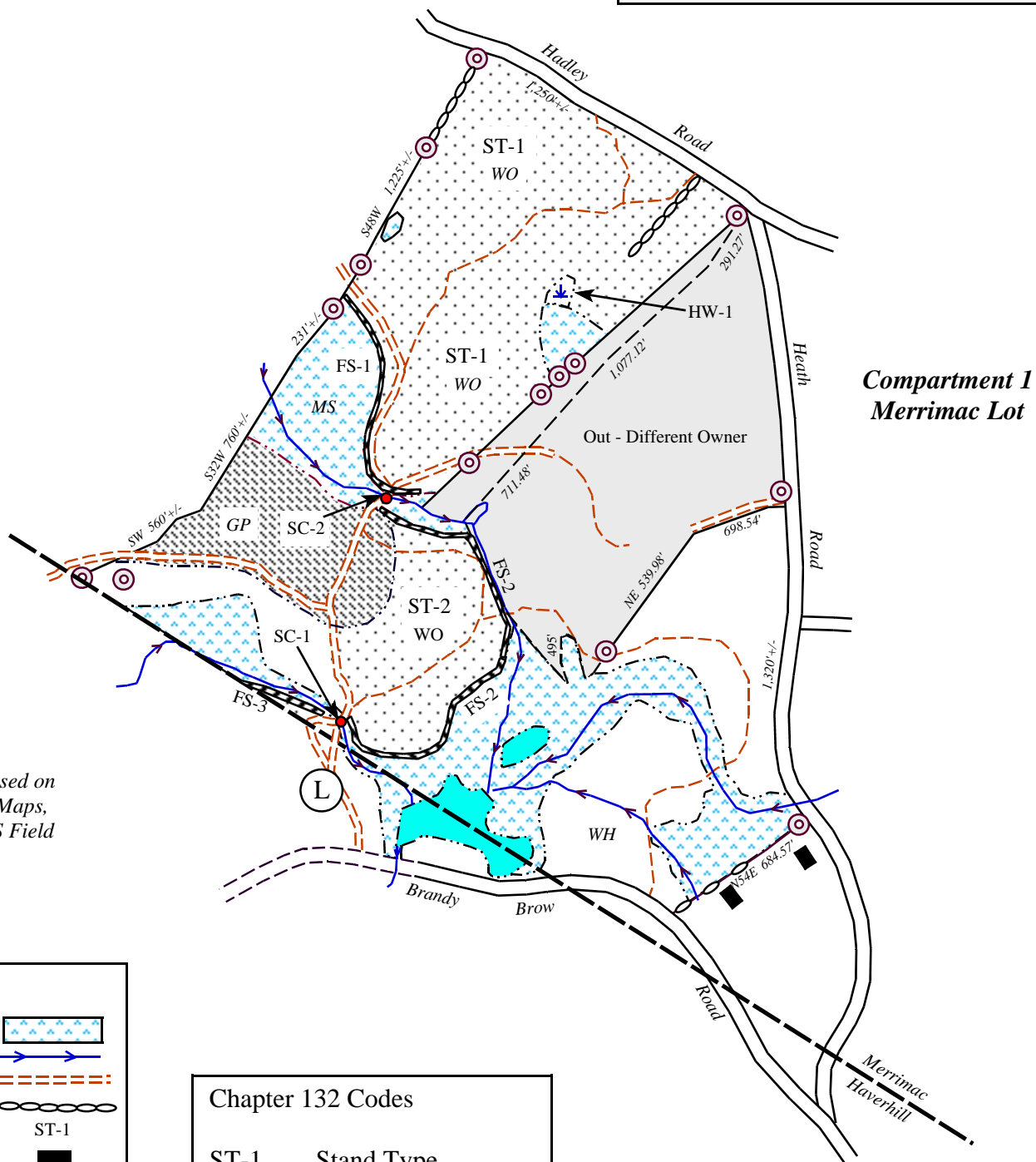







Owned By:
City of Haverhill
Haverhill Conservation Department

Prepared By:
Gary H. Gouldrup
Consulting Forester
72 Townsend Street
Pepperell, MA 01463
978-433-8780
3/28/2011





Metes and bounds are based on the Haverhill Assessor's Maps, Surveys of Land and GPS Field Work 2011.

Legend

Wetland		
Stream		
Access Road		
Stone Wall		
Stand Type		ST-1
Building		
Trails		
Harvest Area		
White Pine Hardwood		<i>WH</i>
White Pine		<i>WP</i>
Mixed Hardwoods		<i>MH</i>
Oak-Hardwoods		<i>OH</i>
River Flood Plain		<i>MS</i>
Stand Type Line		
Iron Pipe		IP
Stone Bound		SB
Assessor's Lot Line		

Chapter 132 Codes

ST-1	Stand Type
SC-1 	Stream Crossing
HW-1	Wetland Harvesting
FS-1	Filter Strip 
L	Wood Landing

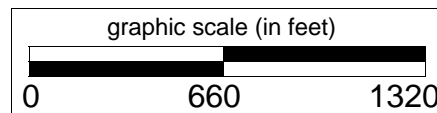



Prepared By:
Gary H. Gouldrup
Consulting Forester
72 Townsend Street
Pepperell, MA 01463
978-433-8780
3/28/2011

BOUNDARY & STAND TYPE MAP

Land in Haverhill, MA
East Meadow Brook Lot

Owned By:
City of Haverhill
Haverhill Conservation Department

Compartment 2 Brandy Brow North Lot

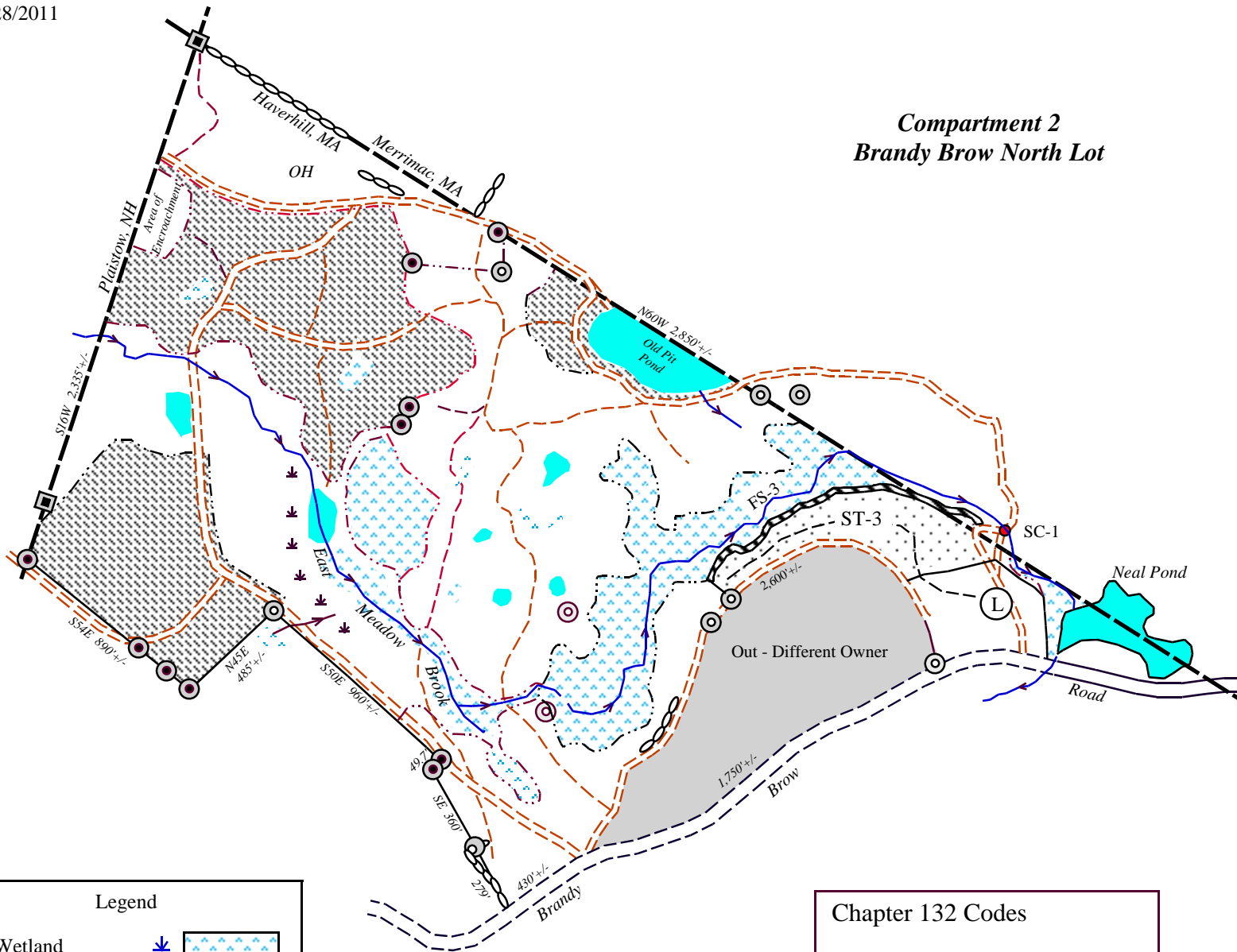

Legend

Wetland	
Stream	
Access Road	
Stone Wall	
Stand Type	ST-1
Building	
Trails	
Harvest Area	
White Pine Hardwood	WH
White Pine	WP
Mixed Hardwoods	MH
Oak-Hardwoods	OH
River Flood Plain	MS
Stand Type Line	
Iron Pipe	
Stone Bound	
Assessor's Lot Line	

Chapter 132 Codes

ST-1	Stand Type
SC-1	Stream Crossing
HW-1	Wetland Harvesting
FS-1	Filter Strip
L	Wood Landing

graphic scale (in feet)

0 660 1320

LOCUS MAP

Land In:
Haverhill & Merrimac, MA

Owned By:
City of Haverhill, Conservation Dept.
City Hall Room 210, 4 Summer Street
Haverhill, MA 01464

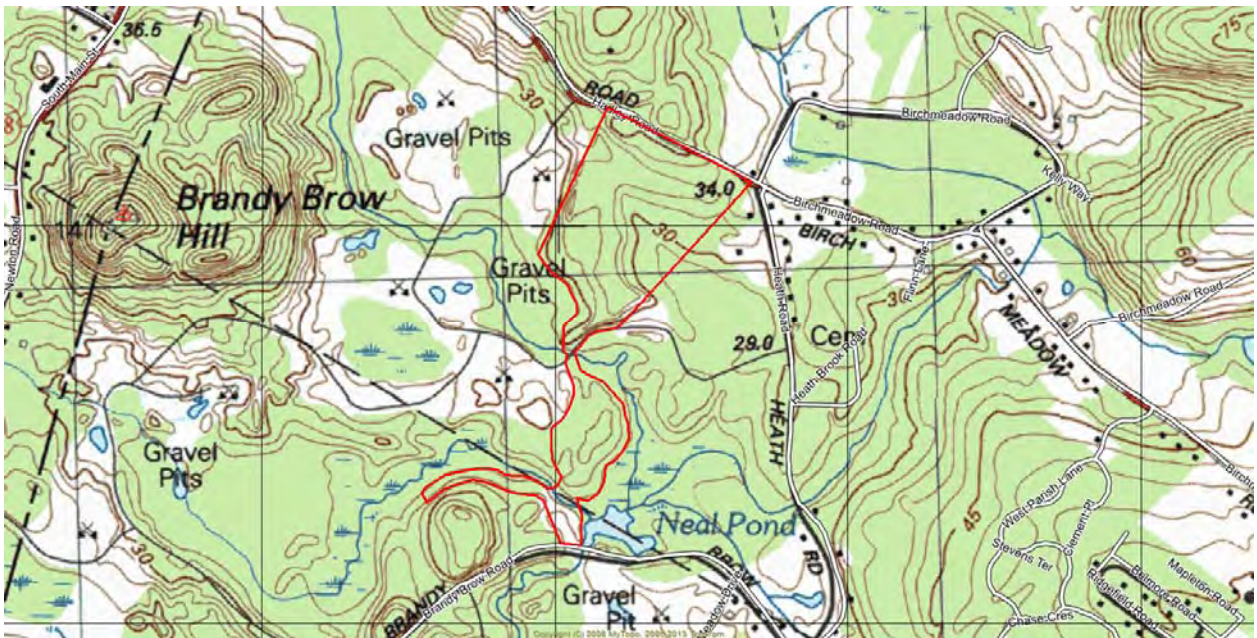

Topographical Map – Haverhill Quadrangle

Scale 1 inch = 1000 feet

September 26, 2013

Prepared By: Gary H. Gouldrup, New England Forestry Consultants, Inc.